

Pringo P232 Plus User's Manual

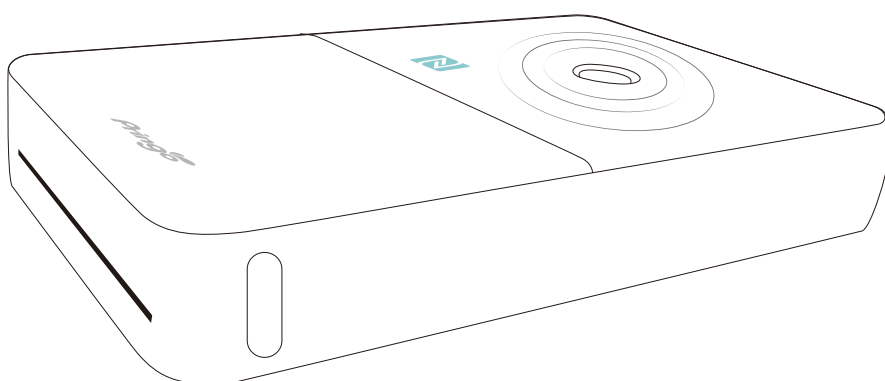

Safety Information

Before you use, operate, disassemble the product, or change or remove any parts, components or materials of the product, please ensure that you carefully read this P232 User's Manual ("Manual") and the safety instructions described below, and strictly follow the instructions of such safety information.

If there is any question regarding the product and you feel the information provided in the Manual does not provide adequate assistance in terms of solving the problem you are facing, please contact our customer service staff immediately for professional assistance with troubleshooting.

For your own safety, HiTi Digital, Inc. ("HiTi") strongly recommends the use of HiTi manufactured and/or designated consumables, accessories, or peripherals of the product ONLY. HiTi DOES NOT GUARANTEE, implied or expressly, the compatibility of the product with any non-HiTi made consumables, accessories, or peripherals. Using any non-HiTi made/designated consumables, accessories, or peripherals which are intended for the product only may damage the product, and/or causes personal injuries and property damages to the user and/or any third parties.

DO NOT ALLOW MINORS UNDER THE AGE OF 12 TO USE, OPERATE, HANDLE OR STORE THE PRODUCT AND/OR ITS BATTERY AND CHARGER PACK.

ALL USE, OPERATION, HANDLING OR STORING OF THE PRODUCT, ITS BATTERY AND CHARGER PACK, AND ANY OTHER CONSUMABLE OR ACCESSORIES BY ADOLESCENTS ABOVE 12 SHALL BE CARRIED OUT IN THE PROPER PRESENCE AND CONSTANT SUPERVISION OF FULLY CAPABLE LEGAL GUARDIANS. THE MANUAL AND ALL THE SAFETY INSTRUCTIONS THEREIN SHALL BE READ TO SUCH ADOLESCENTS PRIOR TO ANY USE, OPERATION, HANDLING OR STORAGE OF PRODUCT OR ITS BATTERY AND CHARGER PACK.

PLEASE BE ADVISED THAT WE WILL NOT BE RESPONSIBLE FOR ANY INJURIES OR DAMAGES IN PERSON OR PROPERTY IN ANY FORM, DIRECT OR CONSEQUENTIAL, INCURRED DUE TO USER'S FAILURE TO FOLLOW STRICTLY THE INFORMATION AND SAFETY INSTRUCTIONS PROVIDED IN THE MANUAL, OR DUE TO ANY USE OF PRODUCT FOR UNINTENDED PURPOSES.

The printer may cease printing for a while when temperature is high.

Notice

Hereby HiTi declares that Pringo P232 is in compliance with the essential requirements and other relevant provisions of Directive 1999/5/EC.

FCC Notice

You are cautioned that changes or modifications not expressly approved by the part responsible for compliance could void the user's authority to operate the equipment.

This equipment has been tested and found to comply with the limits for a Class B digital device, pursuant to part 15 of the FCC rules. These limits are designed to provide reasonable protection against harmful interference in a residential installation. This equipment generates, uses and can radiate radio frequency energy and, if not installed and used in accordance with the instructions, may cause harmful interference to radio communications. However, there is no guarantee that interference will not occur in a particular installation. If this equipment does cause harmful interference to radio or television reception, which can be determined by turning the equipment off and on, the user is encouraged to try to correct the interference by one or more of the following measures:

- Reorient or relocate the receiving antenna.
- Increase the separation between the equipment and receiver.
- Connect the equipment into an outlet on a circuit different from that to which the receiver is connected.
- Consult the dealer or an experienced radio/TV technician for help.

This transmitter must not be co-located or operating in conjunction with any other antenna or transmitter.

This equipment complies with the FCC/IC radiation exposure limits set forth for uncontrolled equipment and meets the FCC radio frequency (RF) Exposure Guidelines in Supplement C to OET62 and RSS-102 for the IC radio frequency (RF) Exposure rules. This equipment has very low levels of RF energy that is deemed to comply without maximum permissive exposure evaluation (MPE). But it is desirable that it should be installed and operated with at least 20cm or more between the radiator and person's body (excluding extremities: hands, wrists, feet, and ankles).

This equipment complies with Part 15 of the FCC Rules. Operation is subject to the following two conditions:

- (1) this device may not cause interference, and
- (2) this device must accept any interference, including interference that may cause undesired operation of the device.

Battery Warnings

Please be advised that charging the product and/or its originally supplied battery with any means, accessories, peripherals, or components other than the HiTi-made/designated charger can directly lead to overheating, meltdown and/or explosion of battery, and thereby causing damages of the product and the personal injuries and/or property damages to the user and/or any third parties.

KEEP THE PRODUCT (WHEN IN USE OR OTHERWISE), AWAY FROM MINORS AT ALL TIMES. DO NOT ALLOW CHILDREN TO PERFORM CHARGING OR USE THE PRODUCT WITHOUT PROPER PRESENCE AND SUPERVISION OF ADULTS.

Please follow strictly all the instructions and safety precautions (including but not limited to correct use, proper handling, etc.) Any improper or incorrect use, or handling of the battery of the product may cause injuries and damages to the user or third parties, and HiTi will NOT be liable for any such damages or liabilities of any form.

If the owner of the product should decide to allow any third party to use the product, including but not limited to handling, maintaining, storing, or charging/discharging the product, it would be the owner's sole responsibility to request such third party user to read carefully and follow strictly the instructions and safety precautions prescribed in the Manual. The owner should be fully responsible for any injuries/damages caused to said third party-user and allow such third party user to use the product at the product owner's own risk.

Battery Cautions

- The battery shall be charged or discharged within a range of temperature 0-40°C (32-104°F). If the battery is charged at the temperature out of the specified range, leakage, heat generation or other damage may be caused.
- Do not use the battery in other product.
- Do not drop or impact the battery.
- Do not attempt to disassemble or open, crush, deform, puncture, shred or alter the battery.
- Do not apply water or liquid of any kind to the battery.
- Store the battery well out of the reach of children; or, supervise children battery usage,
- Store the battery in an indoor location with low relative humidity and between the temperature of 0-25°C (32-77°F). If the battery is subject to store more than 3 months, it is recommended to recharge the battery periodically.
- Do not use a battery that appears damaged or deformed, has any rust on its casing, is discolored, overheats, or emits a foul odor.
- Keep metallic conductive objects away from battery terminals. Metal objects in contact with the connectors can cause a short circuit and damage.
- Immediately flush water over parts of the body or clothing that come into contact with the inner contents of a battery if the outer casing incurs damage. If any of the substances should contact internal tissues, such as eyes or the mouth, immediately flush with water and seek medical assistance.
- Improper use of the battery may result in a fire, explosion, or other such hazards.
- Take extra precautions to keep a leaking battery away from fire. There is a danger of ignition or explosion.
- Promptly dispose of used batteries in accordance with local regulations.

Copyrights & Disclaimer of Warranties

All rights reserved. The information contained in this user manual is subject to change without notice. HiTi makes no warranty with regard to the material, including, but not limited to, the implied warranties of merchantability and fitness for a particular purpose. HiTi Digital, Inc. will not be liable for errors contained herein or for incidental or consequential damages in connection with the furnishing, performance, or use of the material.

iOS and App Store are a trademark of Apple Inc. Android and Google Play is a trademark of Google Inc. All other trade names and trademarks are properties of their respective owners.

Disclaimer of USER'S MANUAL

YOU acknowledge that nothing in MANUAL gives YOU a right to use any of HiTi's trademarks, service marks, product or service names, slogans, and logos or images unless YOU have agreed otherwise in writing with HiTi. The information contained in this MANUAL is subject to change without notice. YOU acknowledge that HiTi reserves the right to modify the MANUAL at any time, and each such modification shall be effective upon posting on the WEBSITE (<http://www.hiti.com>), and such reference shall constitute an integral part of the MANUAL and warranty. YOUR continued use of the WEBSITE following any such modification will be deemed YOU agree to be bound by and YOUR acceptance of the modified Content. It is therefore important that YOU read and visit this WEBSITE on a regular basis to ensure YOU are updated as to the applicable MANUAL and related notices. If YOU do not agree to be bound by these NOTICES and to abide by all applicable law, YOU must discontinue using the WEBSITE immediately and contact our customers' service about your problem.

Component Guide

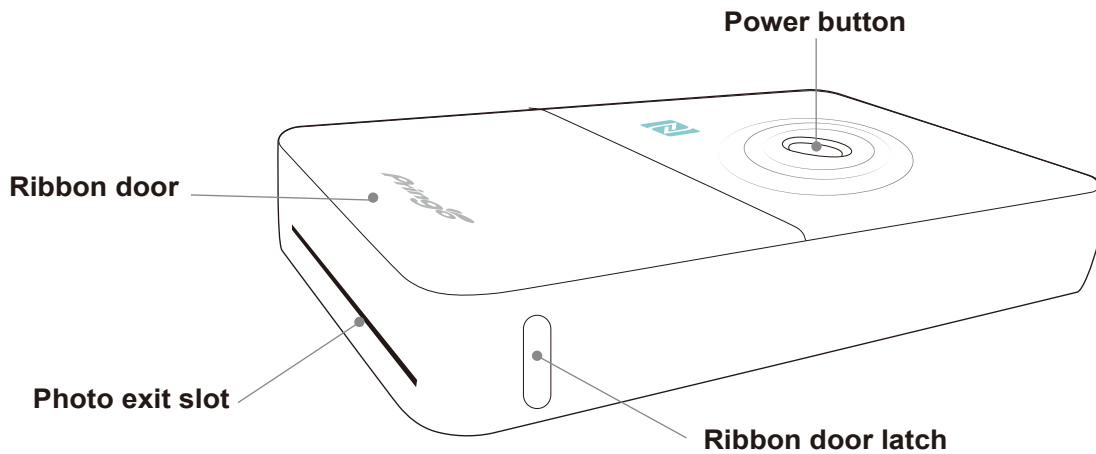

Power button LED

Color	Message
Solid White	Ready to print
Blink White	Print
Blink Red	Error (Pringo APP will show the error message: run out of paper or ribbon, etc.. It will disappear once fill in)
Solid Orange	Low Battery
Solid Blue	Charging
Solid Blue and White: Charging and ready to print. Note: it won't charge the printer while printing. Once finish the printing, it will then begin to charge (Please note the charger is 5V 2A).	Charging while turning on the printer
Solid Blue and White: Charging and ready to print. Note: it can not print while the battery is too lowcharger is 5V 2A).	Charging while turning on the printer (Low battery)

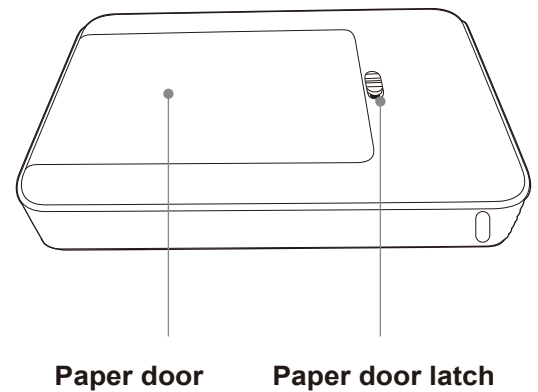

Note

- LED shows the status of the printer. You may also tap  in the App to check for printer status and troubleshooting instructions.
- For complete instructions, please refer to the section “troubleshooting” on P. 9.

Connect Prinhome via NFC: (Android system supported only.)

1. Please switch on NFC on your mobile or
2. Touch the printer on logo  with your device. Notice: Make sure your device is switched on and screen unlocked.
3. NFC will wake up Prinhome APP automatically and create connection with the Printer.



Note

- The battery is not fully charged at shipment. Charge the battery before use.
- Charging time: 3.5 hours using the supplied adapter (5V,2A)(excluded) Charging time may be longer when charged with PC, other low-power USB port or other adapter.
- The printer may print 50 sheets continuously with a fully charged battery*
- Unplug the charger when not in use

* Under the condition of HTi laboratory test

Installing consumable

• Ribbon

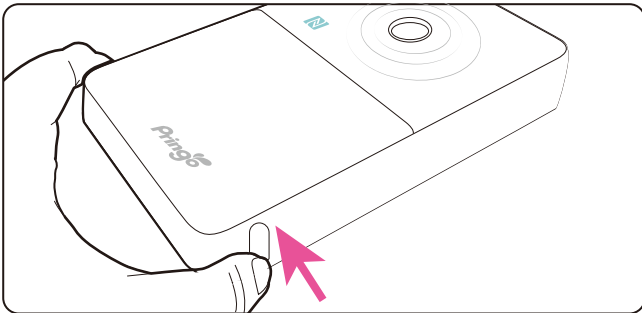

1. Press the ribbon door latch

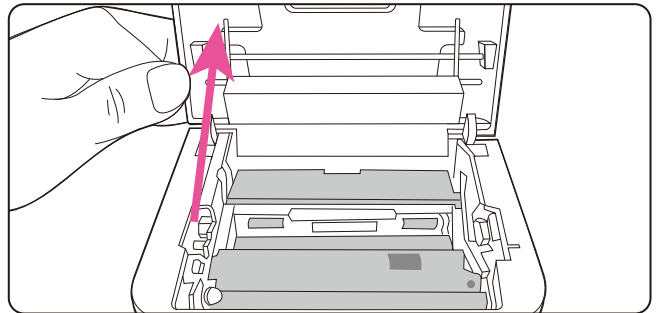

2. Lift the ribbon door

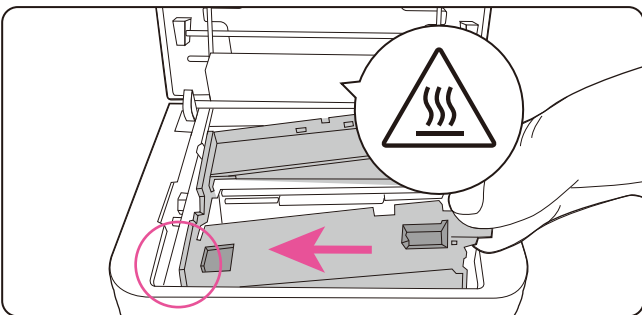

3. Insert the ribbon

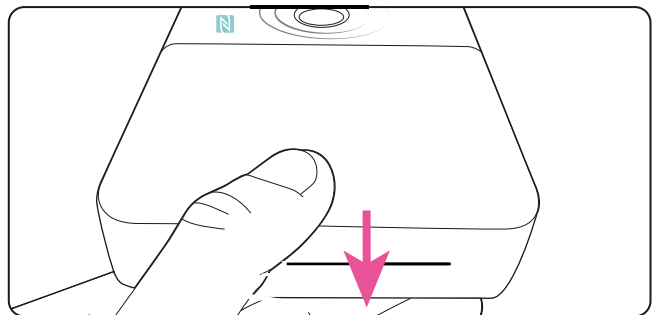

4. Close the ribbon door

**Note**

The printing head needs to be heat up in order to perform the intended functions of the product properly. Therefore it is inevitable that the printing head becomes HOT WHILE PRINTING. DO NOT TOUCH THE PRINTING HEAD DURING PRINTING PROCESS! DO NOT TOUCH THE PRINTING HEAD RIGHT BEFORE OR AFTER THE PRINTING PROCESS! Touching the printing head is likely to cause additional damages to the product, other than jeopardizing the product user's, or any other third party's, personal safety.

• Paper

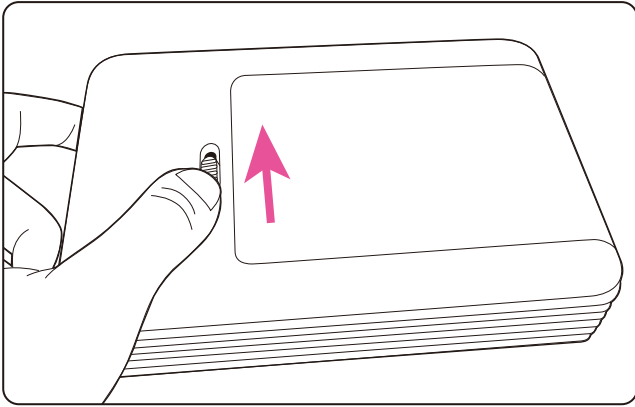

1. Push the paper door latch

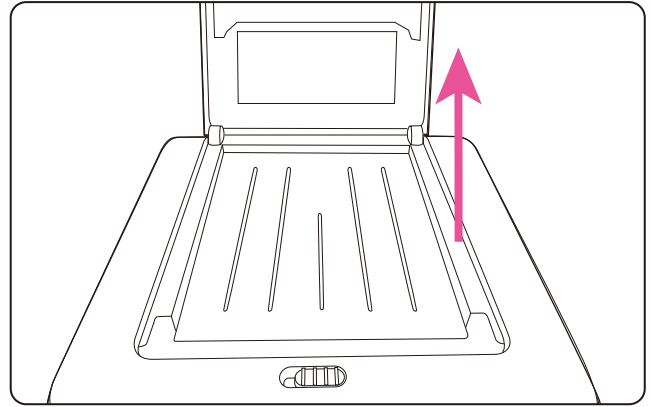

2. Lift the paper door

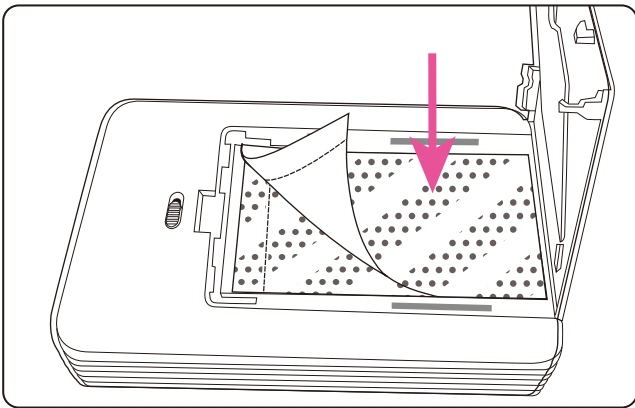

3. Load paper with glossy side facing down, detachable border toward the paper door latch

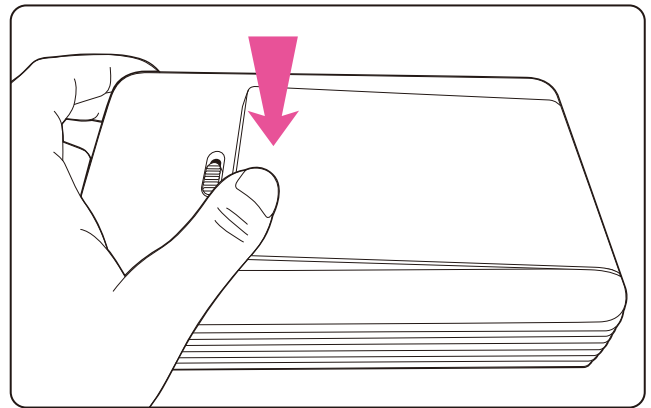

4. Close the paper door

Note

- Works only with HiTi printing kits.
- Please always load 5 photo papers when paper tray is empty.
- Only hold the paper by its margins; avoid touching the printer surface with your fingers.
- Do not reuse paper for printing on the blank part

Turning on & off the printer

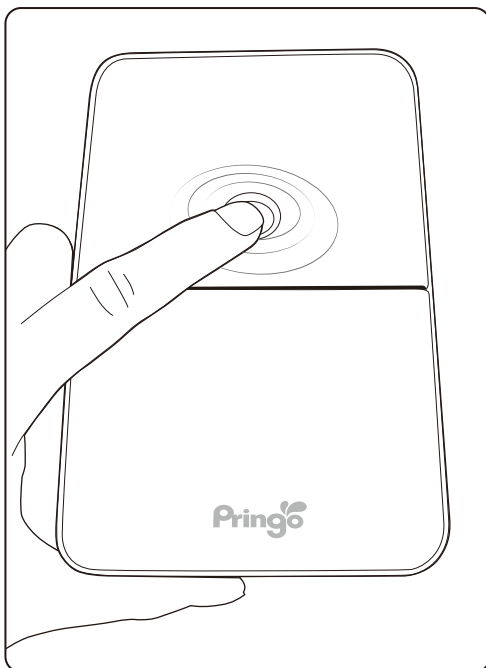

- **Power on**
press 1 second
- **Power off**
press 3 seconds

Download App to print

On iOS device

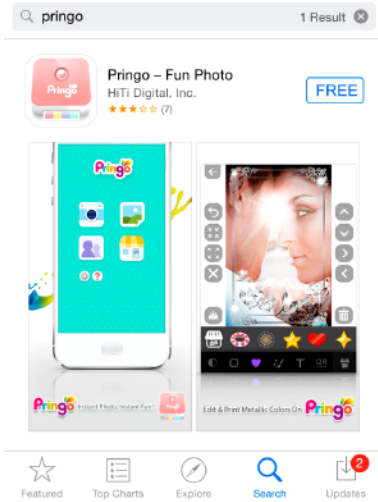

Search for "Pringo" App Store

On Android device



Search for "Pringo" in Google Play



scan barcode
on iOS & Android device

Note

Please download and install the App on your mobile device before printing.

Connecting the mobile device with the printer

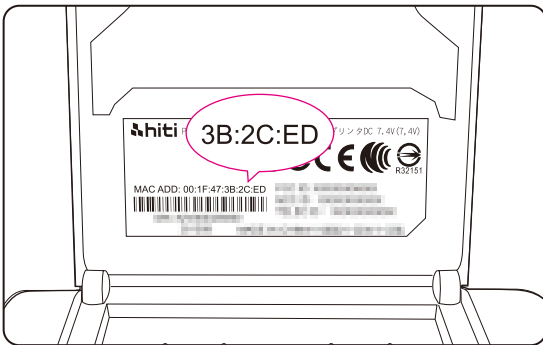

1. Each printer comes with a unique MAC address which is printed on the spec label stuck on inside of paper door. When connecting to the printer, look for the WiFi SSID (network name) "Pringo-the last 6 digits of the printer's mac address" (e.g. "Pringo-3B2CED") on the WiFi setting page on your mobile device.

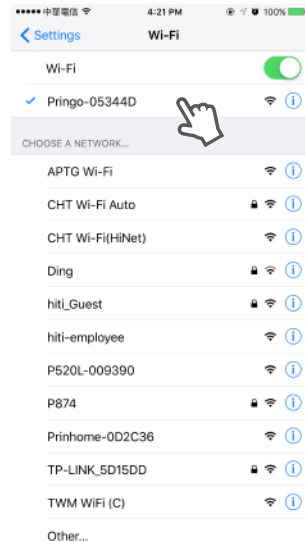

2. Connect to the printer

Note

- You may change printer's WiFi SSID (network name) and setup password in "Printer Settings" in the App.
- Due to the restriction of network architecture, your mobile device may not connect to the printer via WiFi and to 3G network simultaneously.

Quick print

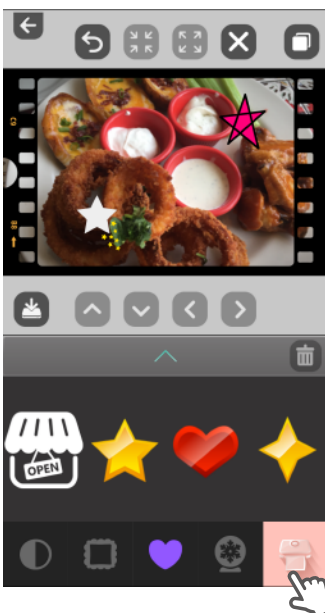

1. Take a new picture or select any photo from album in the App.

2. Tap 

- If your mobile device is not connected to Pringo P232 Plus:

I. Connect to printer via WiFi in WiFi settings on your mobile device (see section "Connecting the mobile device with the printer" on p8)

II. Return to the App and tap  to send the photo to print again.

Note

- Printing quality may be affected by the available RAM on your device.
- The color of the photo may be different from screen.
- The photo makes 5 passes in and out of the printer. Please do not touch or pull the paper before printing is finished.
- Pick up each photo manually before sending another image for printing.
- DO NOT OPEN THE RIBBON DOOR OR PAPER DOOR DURING PRINTING. DO NOT TOUCH THE PRINTING HEAD IN ANY WAY DURING, RIGHT BEFORE, OR RIGHT AFTER PRINTING. Failure to follow these safety instructions may cause damages to the product and/or jeopardize the user's or third party's personal safety.
- Make sure the paper exit slot is clear from obstacle.
- Handle the printer with care to preserve its life. Do not drop the printer or hit it against a hard object. Damage caused by human abuse or improper usage is excluded from the warranty.
- Please wipe the glass on printer head back and forth with alcohol prep pad 2 times gently after every 100 prints. You may continue printing until the alcohol evaporates and any remaining fibers are removed from the printer head. Please be noted that fibers on the printing head may cause printout defects (such as banding).

Printer Settings

After connecting your mobile device with the printer via WiFi, you may find the information about the App, printer firmware, printer battery and other settings here.

• Firmware Version

- Read the details of the update and update manually.
- Please don't turn off the printer or remove the battery during updating.
- Printer will reboot automatically when finishing update.

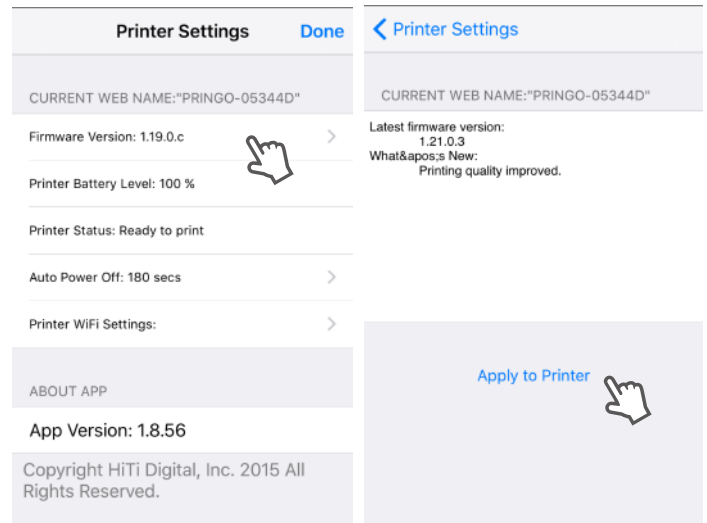

• Auto Power Off

- Printer will be shutdown automatically when idle for more than 3 minutes by default. You may change or turn off the setting.
- The longer Auto Power Off setting is the more power will be consumed while idle (battery life may be affected by the setting).

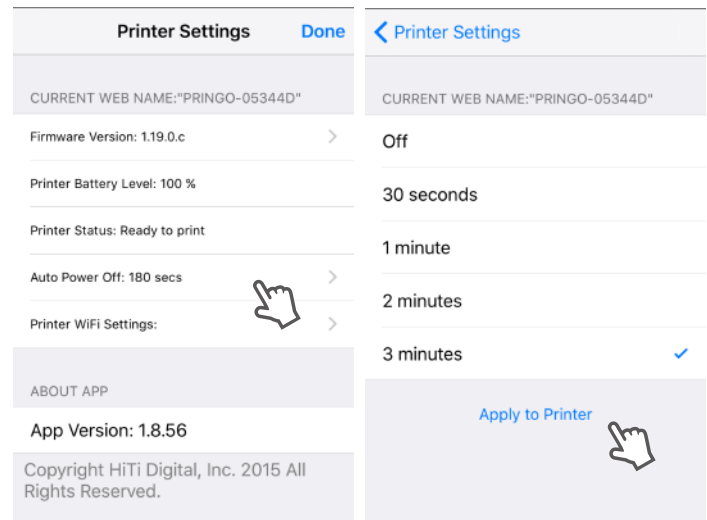

• Printer WiFi Settings

- You can change printer WiFi SSID (network name) to a more memorable name in the setting.
- Setting up password may help to prevent your printer from unauthorized printing.

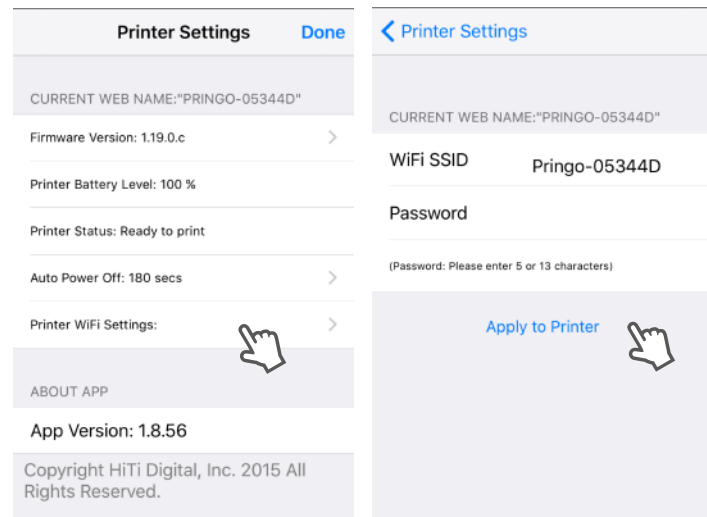

Troubleshooting

If a problem occurs with the printer (when LED flashes RED), please always tap  for instruction of troubleshooting.

When the problem is solved, send the photo again for printing and follow the steps to remove the error

Problem	Solution
Cover open/Ribbon missing	Close the ribbon door or insert a ribbon
Ribbon out	<ol style="list-style-type: none"> 1. Change a ribbon 2. Tap 'OK' in App and send the photo to print again.
Paper out	<ol style="list-style-type: none"> 1. Load paper to the paper tray 2. Tap 'OK' in App and send the photo to print again.
Paper jammed/ribbon jammed	<ol style="list-style-type: none"> 1. Tap 'OK' in App, jammed paper will be ejected automatically. <ul style="list-style-type: none"> • If jammed paper is not ejected automatically, Please Turn off the printer and pull out paper gently <p>★ If a gentle tug is not sufficient to remove the paper, please contact customer support help desk or your distributor. Do not remove jammed paper/ribbon by force. The printer could be damaged.</p>
Unable to update firmware	Make sure you are using the App "Pringo" to update printer firmware; if the problem persists, please contact customer service support help desk.
The printer's SSID is not displayed on the mobile device	<ul style="list-style-type: none"> • Wait for about 8 seconds after turning on the printer. • Do not use the printer near a device that used 2.4 GHz frequency band such as a microwave oven or Bluetooth since it will cause radio wave interference. • Place the printer and mobile device close and do not place any object between them.
Forget Printer WiFi SSID and/or password	<ol style="list-style-type: none"> 1. Press RESET switch  with the tip of an unfolded paper clip for about 3 second to reset the printer to factory default settings. 2. Connect to the printer with factory default settings after automatic reboot. <p>★ Be sure to install the battery and power on the printer before reset.</p>
Low battery	Recharge the battery with the supplied battery charger
Cooling	Wait for a few seconds the printer to cool down

Specification

Model name	P232
Printing resolution	290 x 290 dpi
Gradation	256 Gradations
Photo Format	JPEG
Print Size	2" x 3.4" (54x86mm)
Printing time	About 60 secs
Dimension	157 x 99 x 28 mm
Weight	About 398g ± 10g
Power source	DC 7.4V
Operation temperature	15°C - 32 °C
Operation humidity	20% RH - 90% RH
Battery pack	Voltage 7.4V Capacity 2600 mAh
Adapter (excluded)	Input 100-240V 50/60Hz Max 0.2A Output 5V 2A